

# High Desert Turning

Calendar Year Membership: \$25 individual, \$30 family  
 Contact Sheri Luikens at [sheri.luikens@gmail.com](mailto:sheri.luikens@gmail.com) 250-9410

| OFFICERS, DIRECTORS, & COMMITTEES FOR 2015 |                       |                 |                         |                             |                     |
|--|-----------------------|-----------------|-------------------------|-----------------------------|---------------------|
| <b>President:</b>                          | <b>Bill Mantelli</b>  | <b>298-2603</b> | <b>Newsletter:</b>      | <b>Roger Umber</b>          | <b>249-0444</b>     |
| <b>Vice President:</b>                     | <b>John Ellis</b>     | <b>771-1773</b> | <b>Photographer:</b>    | <b>Peter Frazier-Koontz</b> | <b>402-202-7233</b> |
| <b>Treasurer:</b>                          | <b>Sheri Luikens</b>  | <b>250-9410</b> | <b>Raffle:</b>          | <b>Jim Breeden</b>          | <b>352-0159</b>     |
| <b>Secretary:</b>                          | <b>Larry Linford</b>  | <b>870-1601</b> | <b>Librarian:</b>       | <b>Pat Beatty</b>           | <b>710-2497</b>     |
| <b>State Fair:</b>                         | <b>Jim Breeden</b>    | <b>352-0159</b> | <b>Equip/Workshops:</b> | <b>John Ellis</b>           | <b>771-1773</b>     |
| <b>Webmaster</b>                           | <b>Mike Gardner</b>   | <b>298-3190</b> | <b>Green Wood-ABQ:</b>  | <b>Greg Hoefler</b>         | <b>228-1606</b>     |
| <b>Logistics:</b>                          | <b>Gale Greenwood</b> | <b>256-1379</b> | <b>Green Wood SF:</b>   | <b>Eric Hester</b>          | <b>816-509-1333</b> |
| <b>Lead Video:</b>                         | <b>Hy Tran</b>        | <b>844-5417</b> | <b>Assistant Video:</b> | <b>Derek Roff</b>           | <b>438-1820</b>     |

## NEXT REGULAR NMWT MEETING

**May 2, 2015**  
**9:00 A.M. to Noon**

Club members will taking just a few minutes to share something special they use for turning, be it a unique jig, a fixture, or a favorite tool that is used while turning. They'll bring the item, or with very large fixtures, be ready to show pictures of it.

Jigs are inventions, simple to complex, that help with repeated processes to insure uniformity and/or accuracy.

Fixtures are devices that generally work with other tools to do an operation.

Favorite tools can be any tool, not just the typical turning tools, which help you with your turning. This topic is presented every few years and it's always very popular.

We still have space for a few more presenters, so if you have something to share, please call John

Ellis at 505 771-1773 or email him at [nmwtwebman@aol.com](mailto:nmwtwebman@aol.com).

## FUTURE PROGRAMS/ ACTIVITIES

|        |                                  |
|--------|----------------------------------|
| May 2  | <b>JIGS, FIXTURES, AND TOOLS</b> |
| June 6 | <b>RUDY LOPEZ</b>                |
| July   | <b>TBA</b>                       |

## PRESIDENTS CORNER



There are less than eight weeks left before the AAW's 29<sup>th</sup> International Symposium in Pittsburgh, Pennsylvania. So if you're thinking about going, you need to make your reservations soon.

It's not too early to start thinking about the many fine turnings that you're going to enter into the New Mexico State Fair competition this year. This is a great opportunity for us to show our

New Mexico Wood Turners, Vol. 16, Issue 5  
creations to the community and to promote our  
organization.

A couple of weeks ago Alan Hollar, a  
representative from Packard Woodworks  
contacted me with some questions about our local  
chapter. As a result of our conversation, Packard  
Woodworks has donated five \$20.00 gift  
certificates for us to use in our monthly raffle and  
has offered us a 10% discount on any club  
purchases. Also they sent a bunch of catalogs that  
will be available at our meetings. Roger has  
added Packard Woodworks' info to our monthly  
newsletter. Incidentally, the vessel pictured on  
the cover of their 2015 catalog was turned by  
Alan Hollar.

Keep turning and be safe  
Bill

#### APRIL 4 PROGRAM SUMMARY

### Michael Anderson - Custom Tool Handles

Michael is 17 year turner who has been turning  
for about 2 years. He has packed a lot of learning  
and skill development in those two years.

He demonstrated  
making a custom  
modular tool  
handle with inlay.  
The handle is  
longer than  
normal and



profiled for comfort with a definite grip area for  
aggressive cuts. The handle has a couple of  
inserted 1/4 nuts for securing the tool steel in the  
handle.

Materials needed: Wood blank for handle, Inlay  
material, 1" Copper Slip Coupling, about 5 inches  
of 0.75" OD 0.5" ID Steel tubing, 2 -1/4"X 20  
nuts, JB Weld and glue.

First step is selection of wood for the handle and  
inlay. Michael suggested using wood with a  
density greater than 35 pounds per cubic foot and  
NON-TOXIC. The website [www.wood-database.com](http://www.wood-database.com) is good source of information on

May 2, 2015

wood density and toxicity. The inlay wood should  
have similar properties to the handle wood.

Second step is creating the inlay. Cut the handle  
blank at a 45deg angle with a smooth cut. Glue a  
strip of the inlay onto the cut and glue the  
remaining blank onto the inlay, making sure the  
grain lines up. After the glue sets up, make a mark  
from the "toes" of the inlay to the opposite side,  
then made a mark, connect the marks and that is  
your cut line for your second cut. (The Black line  
in the diagram is  
the second saw  
line.) Glue the inlay  
to the second cut,  
then the blank back  
together. Make sure  
the wood grain lines up.



Next step is to install the steel tubing. Drill a hole  
in the center of the glued up blank, as close to the  
center of the blank and as straight as possible.  
This hole will be the center of the tool handle and  
if it's off-center, the inlay will be off-center.  
Before gluing the steel tubing in place, confirm  
that your tool steel will slide easy into the steel  
tubing. Michael mentioned that he was  
unsuccessful in enlarging the center of the tubing  
with a drill bit, thus he makes sure to buy the  
correct sized steel tubing. (Editor Note: the ID  
can be enlarged with a reamer, but make sure to  
work up in small increments.) Glue the tubing  
flush with the end of the blank. Michael glues a  
spacer on the tool end pre-drilled with a 1/2" hole  
to hide the steel, end grain and glue lines.

Next step is to turn the tool end to the ID and  
length of the copper slip coupling. Place the  
prepared blank between centers with the tool end  
toward the tail stock and turn the tool end to the  
ID of the copper. You want to turn the wood just  
to the ID of the copper so that the copper coupler  
snugly fits on to the blank. Michael likes to length  
of the turning to be a little longer than the copper  
and then fill in the gap with a contrasting spacer.

Now turn the rest of the blank to the desired  
profile. Next to the copper, turn the handle to the

New Mexico Wood Turners, Vol. 16, Issue 5  
OD of the copper and the rest of the handle make a profile that feels comfortable for you. Michael reminded us to pay attention to the grain of the inlay and work with the inlay grain.

When you get the desired profile, Michael suggests that 220 grit be the finest used. If the handle still has “some grip”, it is more comfortable to use. Michael reminded us, to do final sand with the grain.

Reverse the handle in the lathe, and finish off the other end.

Michael likes to use a Boiled Linseed Oil finish. Make sure the oily rags are properly disposed of to prevent fire.

Hang in there, we are almost done. The next step is to prepare the copper for inserting the nuts. With a center punch, mark out where the nuts will be installed. With a drill press and a V-block, carefully drill a 1/4” hole through the copper but not through the steel. Drill slowly through the copper to prevent the drill bit from grabbing. Enlarge the hole to 15/32” which with a little tap, the 1/4” nuts can be forced. Set the nuts as deep as possible and use JB Weld to glue the nuts in place. (Keep the threads as clean as possible.) After JB Weld has set, carefully drill the steel tube with a No. 7 drill bit using the nuts as guide. Carefully tap the steel tubing through the nuts, using the threads of the nuts to align the tap to the steel tube. De-bur the inside of the tube so the tool steel slides in easily. Install a couple of 1/4 - 20 set screws and your handle is ready for tool steels and hours of turning joy.

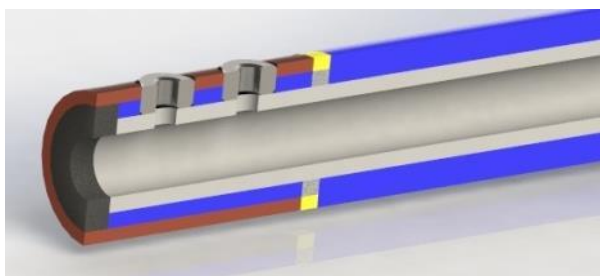

May 2, 2015

This diagram shows what the cross section of the tool end of the handle looks like.

---

## SILENT AUCTION

---

Silent Auction will be held during each NMWT workshop to raise money for a scholarship fund. The earnings from this fund will be used to reduce member’s cost of attending hands-on sessions with professional turner-demonstrators at the discretion of the NMWT Board of Directors.

You may place any item that you think will sell in the auction. Bring only items relating to wood-working or woodturning. There will be auction sheets on a table outside the WWS meeting room. Take a sheet, write the name of the item on the sheet and put your item with the sheet. If you want the item to go for a certain amount, put your name and the minimum bid on the sheet. The Auction will be over at the end of the break. Money will be collected for items sold during the last part of the meeting. All money collected will go into the scholarship fund. Items not sold will be returned to the owner and the owner will remove the items from Woodworkers Supply.

---

## SCHOOLS

---

### **Santa Fe Community College** [www.sfccnm.edu](http://www.sfccnm.edu)

Santa Fe Community College offers both credit and noncredit courses taught by some of the most prominent artisans in the woodworking field. Classes are offered in the Fall, Spring, and Summer sessions. For more information on SFCC classes, contact club member Al Mirman, one of the Woodturning instructors, at 771-0490. Information can also be found at SFCC’s web site.

---

## DISCOUNTS & REBATES

---

### **WOODWORKER’S SUPPLY**

[www.woodworker.com](http://www.woodworker.com)

Meeting Day Specials for the May 2nd meeting will be announced at the meeting.

### **CRAFTS SUPPLY**

[www.woodturnerscatalog.com](http://www.woodturnerscatalog.com)

New Mexico Wood Turners, Vol. 16, Issue 5  
Offers a discount to members on large orders. Craft  
Supply has implemented a new club support program.  
Visit their web site or phone Kathy Lawrence at 1-  
800-551-8876

**ALBUQUERQUE HARDWOOD LUMBER Co**  
NMWT members receive Wholesale Prices. ABQ  
Lumber has hardwoods, Thermofused Melamine,  
plywood, veneers, and furniture grade white pine.

**STOCK BUILDERS SUPPLY**  
*www.stockbuildingsupply.com*  
5815 Edith Blvd NE  
Albuquerque, NM 87107  
(505) 345-2865  
Wholesale Prices to NMWT Members

**ALBUQUERQUE EXOTIC WOODS**  
*www.abqexoticwoods.com*  
Jake Jacobson has a store specializing in exotic  
woods, located at 4224 Menaul Blvd NE.

Hours: Tuesday through Sunday, 8:30 – 6:00.  
(Monday by appointment)  
Contact: (505) 293-WOOD (9663)

**PACKARD WOODWORKS INC.**  
The Woodturner's Source  
1-800-683-8876  
packardwoodworks.com

**CRANE MOUNTAIN WEAPONS**  
Contacts: Pat, Marti, or Joe - 271-0797. This  
business uses exotic woods for gunstocks and  
sells off-cuts as turning blanks.

---

### LUMBER & MILLING SERVICES

---

|                |              |
|----------------|--------------|
| Wes Thompson   | 505-384-2544 |
| Doug Malmstrom | 505-907-3015 |

Custom milling of your lumber or ours.

---

### FOR SALE

---

Remember, your items for sale will run for one month  
unless you request an extension.

May 2, 2015

There is no charge for listing items, and we welcome  
members to use this space for anything related to  
woodturning.

**You can also run an ad to FIND or TRADE  
something.**

---

### INSTANT PHOTO GALLERY

---

The photographer will only be available until 8:45  
A.M. on the day of the meeting to take photos of the  
instant gallery items.



Michael Anderson – Bolivian Rosewood Winged  
Box



Michael Anderson – Ambrosia Maple Platter



Michael Anderson – Dalmata Box





Jim Breeden - Dyed Edge Ambrosia Maple Platter



Bob Stanch – Carved & Dyed Arizona Cypress Bowl



Jim Breeden – Box Elder Hollow Vessel



Bob Stanch – Sassafras Carved Bowl



Bill Kalb – Pecan Platter



Taz Bramlette – Aspen Vase



Bob Stanch – Unknown Burl Bowl



Vic Myers – Carved Locust Bowl



Ed Otero – Chinese Elm Bowl



Ed Otero – Mulberry Bowl



Hy Tran – Walnut Plate



Chris Enke – Mallee(?) Burl Hollow Vessel

**MENTORS**

Members are always welcome to contact the people on the following list for guidance to better turning ideas, and techniques -- Free to members so give a Mentor a call!

| Name         | Phone             | Description  |
|--------------|-------------------|--|
| Bill Zerby   | New #<br>263-6632 | Basic spindle turning & tool sharpening            |
| Dan Shipman  | 296-9754          | Basic turning, hollowing & segmented construction  |
| Irling Smith | 865-9230          | Segmented turning & design                         |
| John Ellis   | 771-1773          | Basic turning, plates, tools & handles             |
| Alan Becker  | 467-8382          | Intermediate Hollowing                             |
| Ron Phillips | 867-0612          | Specialty tools, rests & steadies                  |
| Ralph Watts  | 500-5859          | Advanced turning, carving, coloring, and finishing |
| Ron Bahm     | 881-8845          | Pen turning  |

**LOGO WEAR SHIRTS/ SMOCKS**



**NMWT OFFERS CUSTOM TURNING SMOCKS**

After much looking I have finally found a domestic source for a quality turning smock. A picture accompanies this article. The smock design and material are identical to that offered by AAW. The smocks come in five colors: Royal Blue, Navy Blue, Burgundy, Tan and Grey and in seven sizes: S, M, L, XL, XXL, XXXL, XXXXL. The smocks are sized to fit over a shirt so if you wear an L shirt you should order an L smock. AAW sells their smocks online for \$50 plus about \$9 shipping and handling plus \$3 extra for your name (added here). NMWT will charge \$50 per smock with NMWT logo plus \$3 for your name if desired. The price includes sales tax. The XXXXL size is \$3 extra and there is no price break for volume. A company in Colorado is manufacturing the smocks.

*Normally, if you order and pay for an item at one meeting I can have it at the next; however, if you say please and buy me a cup of coffee, I can probably have it in two weeks.*

### Prices for NMWT's Shirts and Hats

|                          |         |
|--------------------------|---------|
| Long Sleeve Denim Shirt  | \$27.00 |
| Short Sleeve Denim Shirt | \$25.00 |
| Polo (golf) shirt        | \$22.00 |
| Short Sleeve T-Shirt     | \$15.00 |
| Caps (baseball)          | \$11.00 |

- All items include embroidery
- Add \$2 for XXL and \$3 for XXXL
- Names Embroidered on Shirt \$3.00
- Logo on Customer Supplied Garment \$9.00
- Contact: Tom Cour: 867-8771

### LIBRARY CORNER

A good selection of educational DVD's are available for check out during club meetings

### NMWT WEB SITE

[www.nmwoodturners.org](http://www.nmwoodturners.org)

Please visit our web site. Webmaster Mike Gardner continues to made many additions and improvements that are very useful to club members and the public. If you have not been there lately we now have a slide show on the Home Page and the Gallery is divided into sections with slide shows.

### NEWSLETTER ENTRIES

If you have tips, news, "For Sale" or newsletter entry (try to stay 250 words or less, no embedded photos ; send photos as separate attachments), Please send it to [news@nmwoodturners.org](mailto:news@nmwoodturners.org) for publication in a future newsletter. **Must be received by the last Saturday of the month to make the most current newsletter.**

### SUGGESTED OTHER WEB SITES

Found a good WEB site? Want to share it with other club members? Questions or suggestions are welcome. Please contact the club Webmaster Mike Gardner at: [webmaster@nmwoodturners.org](mailto:webmaster@nmwoodturners.org)

[www.cleanturn.net](http://www.cleanturn.net), [www.pennstateind.com](http://www.pennstateind.com),  
[www.tufftooth.com](http://www.tufftooth.com), [www.woodmagazine.com](http://www.woodmagazine.com)  
[www.penturners.org](http://www.penturners.org), [www.woodturnerscatalog.com](http://www.woodturnerscatalog.com)  
[www.WoodTurningz.com](http://www.WoodTurningz.com), [www.woodweb.com](http://www.woodweb.com)  
[www.woodturningvideosplus.com](http://www.woodturningvideosplus.com)  
[www.sofasandsectionals.com/wood-turning-resources](http://www.sofasandsectionals.com/wood-turning-resources)  
[www.woodworkersjournal.com](http://www.woodworkersjournal.com)

Another resource is:  
[www.albuquerque.craigslislist.org](http://www.albuquerque.craigslislist.org)

**New Mexico WoodTurners  
c/o Roger Umber  
12520 Piru Blvd. SE  
Albuquerque, NM 87123**

